

**CUSHMAN &
WAKEFIELD**

Southwestern Ontario

FOR LEASE

**22 Sydenham Street West, Units 1, 2, 3, 4
Aylmer, ON N5H 1M0**



OFFICE/RETAIL | FOR LEASE

Available Space: Approx. 1,679 SF - 5,918 SF

Asking Rent: \$14.00 PSF Net

Additional Rent: \$5.50 PSF

Property Highlights

Prime New Development - Retail/Office/Commercial/Restaurant/Medical/Dental Office space available in downtown Aylmer:

- **Unit 1:** Approx. 5,918 SF - Asking: \$14.00 PSF Net (three available units combined)
- **Unit 2:** Approx. 2,093 SF - Asking: \$14.00 PSF Net
- **Unit 3:** Approx. 2,200 SF - Asking: \$14.00 PSF Net
- **Unit 4:** Approx. 1,679 SF - Asking: \$14.00 PSF Net
- Only 3 commercial units remaining which can be broken down to the above configurations or combined as one large unit for a total of 5,918 SF (Unit 1)
- **Additional Rent:** Inclusive of property taxes and building insurance
- **Zoning:** C1-1 permits a wide range of uses
- **Parking:** Plenty free on-site
- **Signage:** Sigband Signage available
- Other Tenant's currently in the Building: McFarlan Rowlands Insurance
- High Profile Location at the corner of Sydenham Street and John Street, just south of the Aylmer main street (Talbot Street)
- Spaces/Condo units are also For Sale
- Newer 39-unit residential condo building directly above the commercial space
- Park Like setting
- The owner is also able to Build to Suit for qualified tenants
- All offers and inquiries through listing agent at Vendor's request

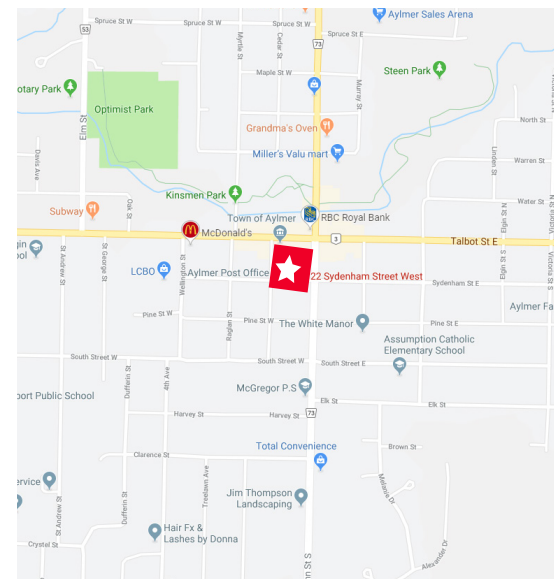

TYLER DESJARDINE

Sales Representative

519 438 5403

tyler.desjardine@cushwakeswo.com

CUSHMAN & WAKEFIELD

Southwestern Ontario

620A Richmond St, 2nd Floor

London, Ontario N6A 5J9

www.cushwakeswo.com

©2020 Cushman & Wakefield Southwestern Ontario, Real Estate Brokerage, Independently Owned and Operated. A Member of the Cushman & Wakefield Alliance.

This information has been obtained from sources believed to be reliable but has not been verified. No warranty or representation, express or implied, is made as to the condition of the property (or properties) referenced herein or as to the accuracy or completeness of the information contained herein, and same is submitted subject to errors, omissions, change of price, rental or other conditions, withdrawal without notice, and to any special listing conditions imposed by the property owner(s). Any projections, opinions or estimates are subject to uncertainty and do not signify current or future property performance. All rights reserved.

22 Sydenham Street West, Units 1, 2, 3, 4

Aylmer, ON N5H 1M8

**ASKING RENT:
\$14.00 PSF Net**

**ADDITIONAL RENT:
\$5.50 PSF**



Floor Plan

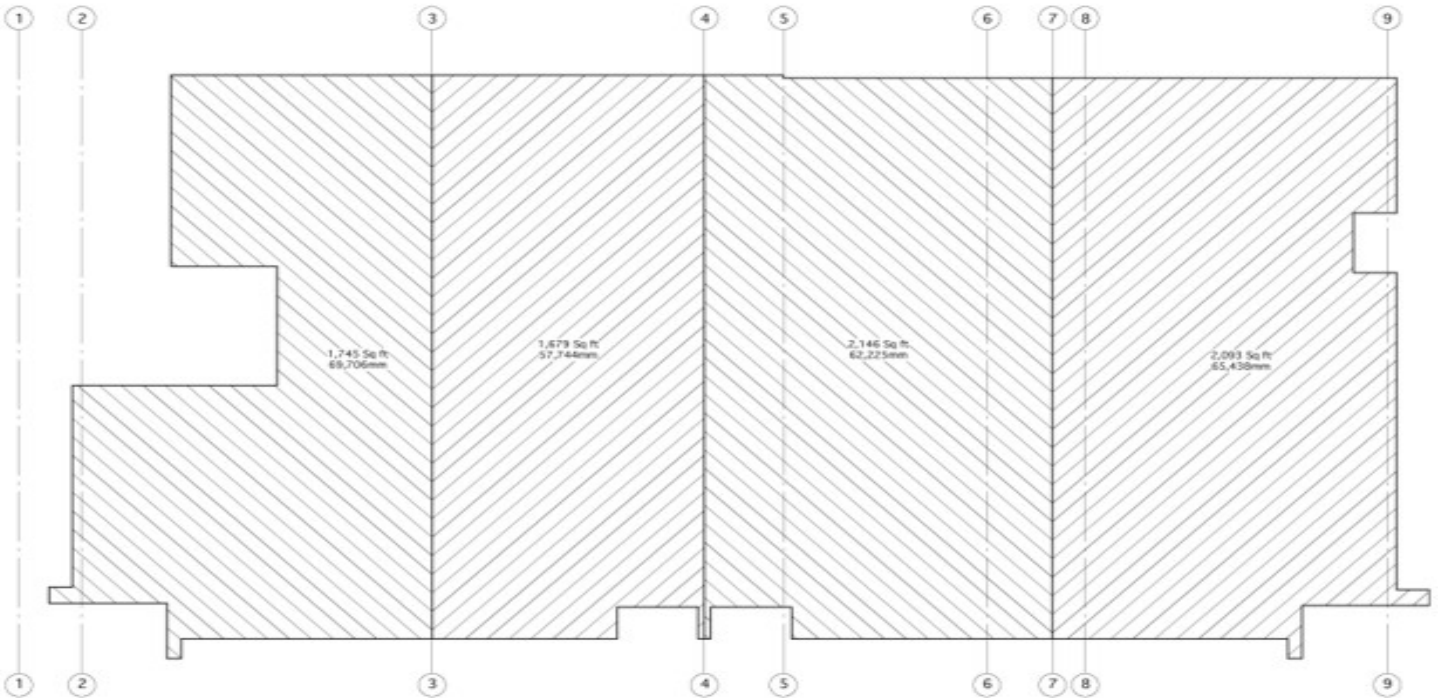

Aerial/Site Plan



TYLER DESJARDINE
Sales Representative
519 438 5403
tyler.desjardine@cushwakeswo.com

CUSHMAN & WAKEFIELD
Southwestern Ontario
620A Richmond St, 2nd Floor
London, Ontario N6A 5J9
www.cushwakeswo.com