



FOR LEASE | PRIME RESTAURANT/RETAIL/OFFICE SPACE

664 RICHMOND STREET

London, Ontario



**CUSHMAN &
WAKEFIELD**

Southwestern Ontario

ABOUT THE PROPERTY

Prime restaurant/retail/commercial/office space available for lease on Richmond Row in London

UNIT	AVAILABLE SPACE	ASKING RENT	ADDITIONAL RENT
1	3,029 SF	\$25.00 PSF Net	\$10.00 PSF (Est.)
2	965 SF	\$28.00 PSF Net	\$10.00 PSF (Est.)

- **Zoning:** BDC(1), BDC 1 - permit's a wide range of uses: restaurants, taverns, retail stores, offices, medical/dental, clinics, bake shops, animal hospitals, gyms, fitness, day care centres, dry cleaning and laundry depots, financial institutions, grocery stores, laboratories, private clubs, service/repair establishments, studios, food store and convenience Store, etc.
- Property is under new ownership and management; undergoing complete renovations with new 2nd floor tenant.
- Tenant to pay for Utilities (gas, hydro & water)
- Unique opportunity to Lease a Historic Building on Richmond Row in downtown London.
- Unit 1 includes a patio area of ±4,000 SF (±40' x ±100') fronting onto Richmond Street .
- Located at the heart of London's most viable retail, office, commercial and restaurant nodes in the core.
- Other Tenants in the area: Jack Astors, Chucks Roadhouse, Ceeps, Barneys, Molly Blooms, Joe Kools etc.



UNIT 1 (Rendering)



UNIT 2



UNIT 2

UNIT 1 FLOOR PLAN

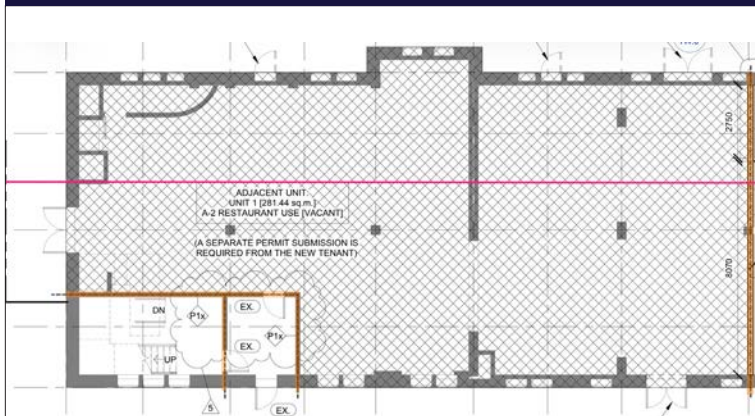

UNIT 2 FLOOR PLAN

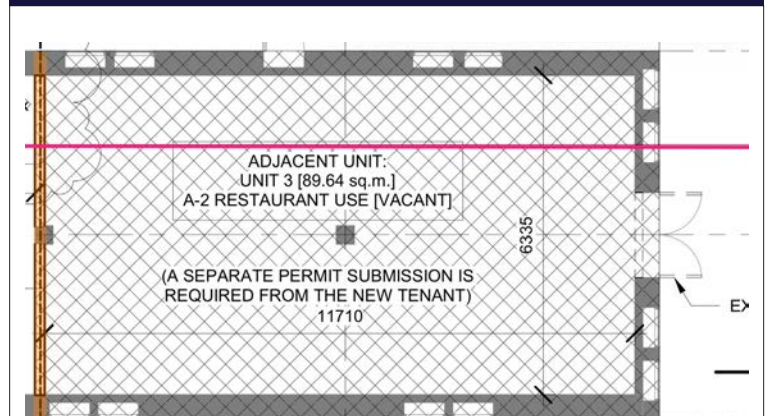

TYLER DESJARDINE
Sales Representative
519 438 5403
tyler.desjardine@cushwakeswo.com

CUSHMAN & WAKEFIELD
SOUTHWESTERN ONTARIO
850 Medway Park Dr, Suite 201
London, Ontario N6G 5C6
www.cushwakeswo.com

CUSHMAN & WAKEFIELD
Southwestern Ontario